



J E F F E R S O N
P L A N T A T I O N

- In Oconee County School District
- Close to beautiful Lake Keowee
- Near the famous mountain town of Highlands, NC and the Blue Ridge Mountains

Office: 864-654-5750

Toll Free: 888-REGAL-55

www.regalhomesofsc.com

From Clemson, take Hwy 123 towards Seneca. Take a right on Hwy 28 towards West Union & Walhalla. Merge right onto West Union Road followed by a right onto Jefferson Road. Dusty Drive will be on your right.

From Greenville, take I-85 toward Atlanta. Exit at #19 toward Clemson on Hwy 76. In Clemson, bear left as Hwy 76 merges with Hwy 123, and continue to Seneca. Take a right on Hwy 28 towards West Union & Walhalla. Merge right onto West Union Road followed by a right onto Jefferson Road. Dusty Drive will be on your right.

PHONE:(864) 638-5888

Hidden Away in the Country, but Conveniently Located Near:

- 68 Restaurants within *5 miles*
- Atlanta International Airport,
1 hour 50 minutes
- Greenville Spartanburg International Airport,
1 Hour
- Oconee Memorial Hospital,
4.18 miles
- 3 animal clinics within *5 miles*
- 10 Grocery Stores within
5 miles:
 - Ingles, 1.52 miles*
 - Wal-Mart, 4.38 miles*
 - Bi-Lo, 4.93 miles*



Quality Built Affordable Homes

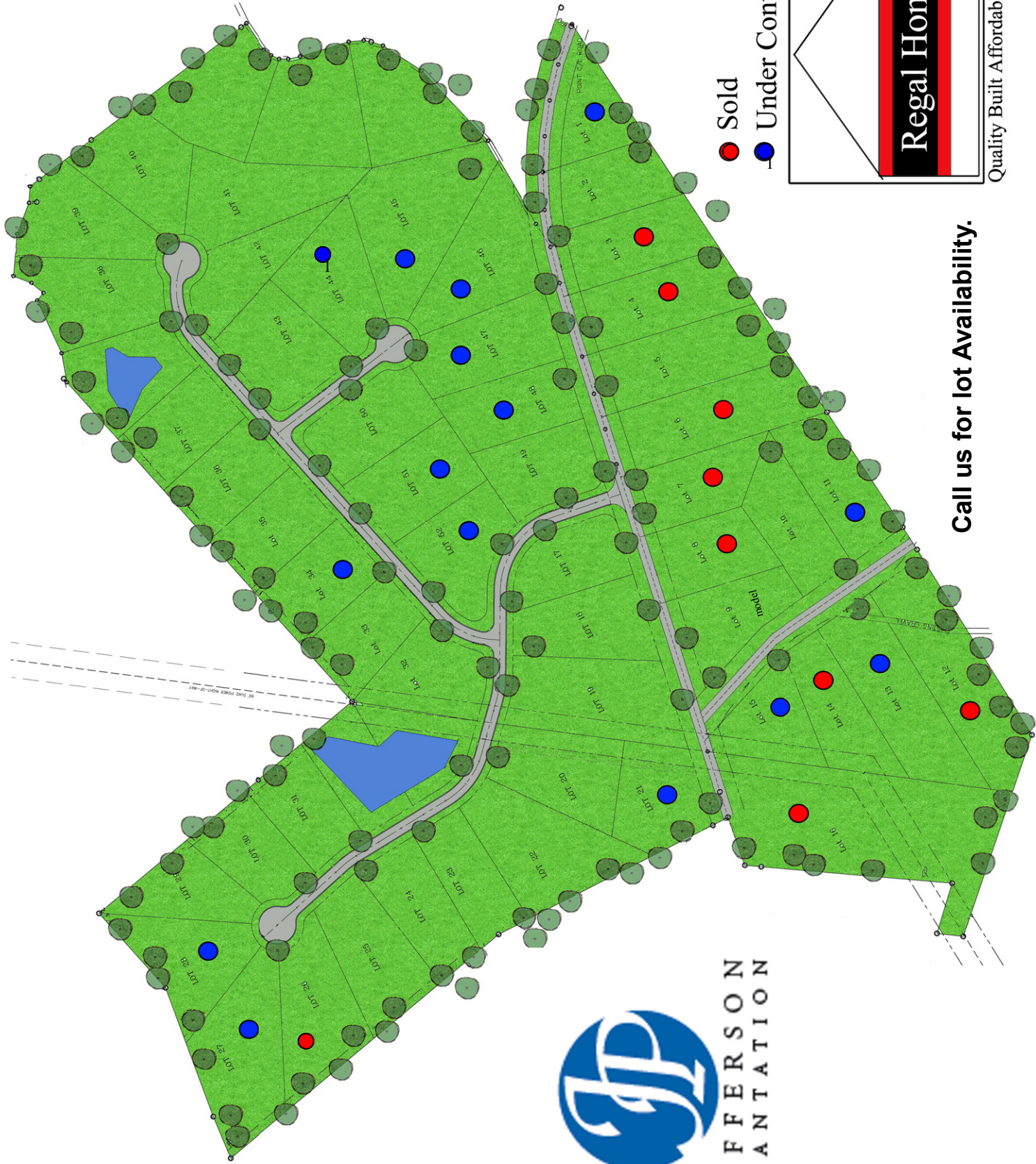

**J E F F E R S O N
P L A N T A T I O N**

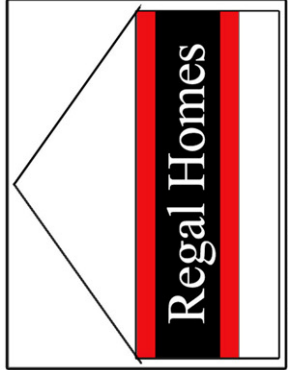

Quality Built Affordable Homes

Call us for lot Availability.